



## COMPACT BLUMOTION Hinge 38N 105°

### Overlay

5/16 in

3/8 in

1/2 in

5/8 in

3/4 in

### Fixing Type

Knock-In with  
Insertion Ram  
Only

Screw-On

### Mounting Type

Edge Mount

Wrap-around  
Mount

### Screw/Nail

Included

Not included

### Packaging format

Per unit

Bag

Bag of 10  
units

## DESCRIPTION

The COMPACT BLUMOTION hinge has been specially designed for framed cabinets. The soft closing function is integrated directly into the hinge housing and can be deactivated for small or light doors. With COMPACT BLUMOTION, the doors always close quietly.

The BLUMOTION function can easily be deactivated on a hinge, allowing small or light doors to close with the same high quality of movement.

## ADVANTAGES AND BENEFITS

- BLUMOTION soft-close integrated into the hinge cup - Deactivation switch for small/light doors - Overload safety feature - One-piece wraparound hinge - 7/16 po (11 mm) cup depth

## AVAILABLE PRODUCTS

Product #	Overlay	Fixing Type	Mounting Type	Screw/Nail	Packaging format
<b>38N358B05180</b>	5/16 in	Knock-In with Insertion Ram Only	Wrap-around Mount	Not included	Per unit
<b>38N358B06180</b>	3/8 in	Knock-In with Insertion Ram Only	Wrap-around Mount	Not included	Per unit
<b>38N355B06180</b>	3/8 in	Screw-On	Wrap-around Mount	Not included	Per unit
<b>38N358BE08180</b>	1/2 in	Knock-In with Insertion Ram Only	Edge Mount	Not included	Per unit
<b>38N358B08180</b>	1/2 in	Knock-In with Insertion Ram Only	Wrap-around Mount	Not included	Per unit
<b>38N355BE08180</b>	1/2 in	Screw-On	Edge Mount	Not included	Per unit
<b>BP38N355B08180U</b>	1/2 in	Screw-On	Wrap-around Mount	Included	Bag
<b>AP38N355B08180U</b>	1/2 in	Screw-On	Wrap-around Mount	Included	Bag of 10 units
<b>38N355B08180</b>	1/2 in	Screw-On	Wrap-around Mount	Not included	Per unit
<b>38N358B10180</b>	5/8 in	Knock-In with Insertion Ram Only	Wrap-around Mount	Not included	Per unit
<b>38N358B12180</b>	3/4 in	Knock-In with Insertion Ram Only	Wrap-around Mount	Not included	Per unit
<b>38N355B12180</b>	3/4 in	Screw-On	Wrap-around Mount	Not included	Per unit

## TECHNICAL SPECIFICATIONS

<b>Hinge Type</b>	COMPACT BLUMOTION
<b>Brand</b>	Blum
<b>Finish</b>	Nickel
<b>Material</b>	Steel
<b>Milling Diameter</b>	1 3/8 in*
<b>Use Type</b>	Standard Door
<b>Cabinet Type</b>	Face Frame
<b>Door Position</b>	Half Overlay
<b>Cabinet Thickness</b>	Min. 5/8 in*
<b>Door Thickness</b>	5/8 in*
<b>Closing Mechanism</b>	Soft-Closing
<b>Milling Depth</b>	7/16 in*
<b>Hinge Opening Angle</b>	+105°

### Disclaimer

Measures shown with an asterisk (\*) have been converted as per your preference. These are not the official measures. To view the measures specified by the manufacturer, [click here](#).

---

## IMPORTANT INFORMATION

The best way to clean your Blum fittings is as follows: - Use a soft, lint-free cloth, a chamois leather or a sponge - Ensure that the material you use to wipe the furniture with is just damp, not wet - Always wipe the furniture again afterwards with a dry cloth - If possible, use cleaning products intended specifically for materials such as leather, stainless steel etc.; otherwise, use only clean water - Wipe off dirt as soon as it appears AVOID THE FOLLOWING: - using steam cleaners - using cleaning products, such as abrasive cleaning powder, steel wool and scourers, as well as cleaning agents, such as acetone, chlorine, cellulose thinner and solutions whose names start with tri or tetra - storing open cleaning products, baking powder, dishwasher products or table salt, for example. Fumes can cause corrosion on all metal surfaces.

## APPLICATION

- For the installation of a door on a piece of furniture and/or a cabinet. - Blum hinges are not made of stainless steel, therefore it is not recommended to use them for outdoor applications.

## PRODUCT PHOTOS

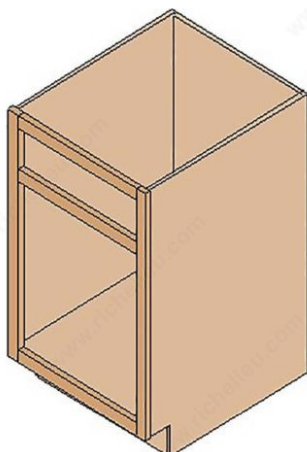

Armoire à cadre  
Face Frame / Framed

